

Top view

SPECIFICATION PLATE LOCATION

(2) POLYLOK 508MM (20") Ø RISERS & LIDS
PART No. 3009, 3009-RC

NOTE:
MATERIAL: CONCRETE 32MPa @ 28 DAYS, NON-SULFATE
AIR ENTRAINMENT: 5-7%
REINFORCEMENT: CAN/CSA-G30.18
CONSTRUCTION: MEETS CSA B66-05
TOTAL WEIGHT: 4250 kg (9370 LBS)
TOTAL VOLUME: 3600 L
MONOLITHIC CAST CHAMBER DIVIDER
INLET/OUTLET: CAST-IN 102MM (4") Ø PVC GASKETED COUPLER
BAFFLE: 102MM (4") Ø PVC
JOINT: N/A
ASSEMBLY: AT FACTORY
MAX. BURIAL DEPTH: 1.2M (47.25")
ALL DIMENSIONS IN MM
INCHES

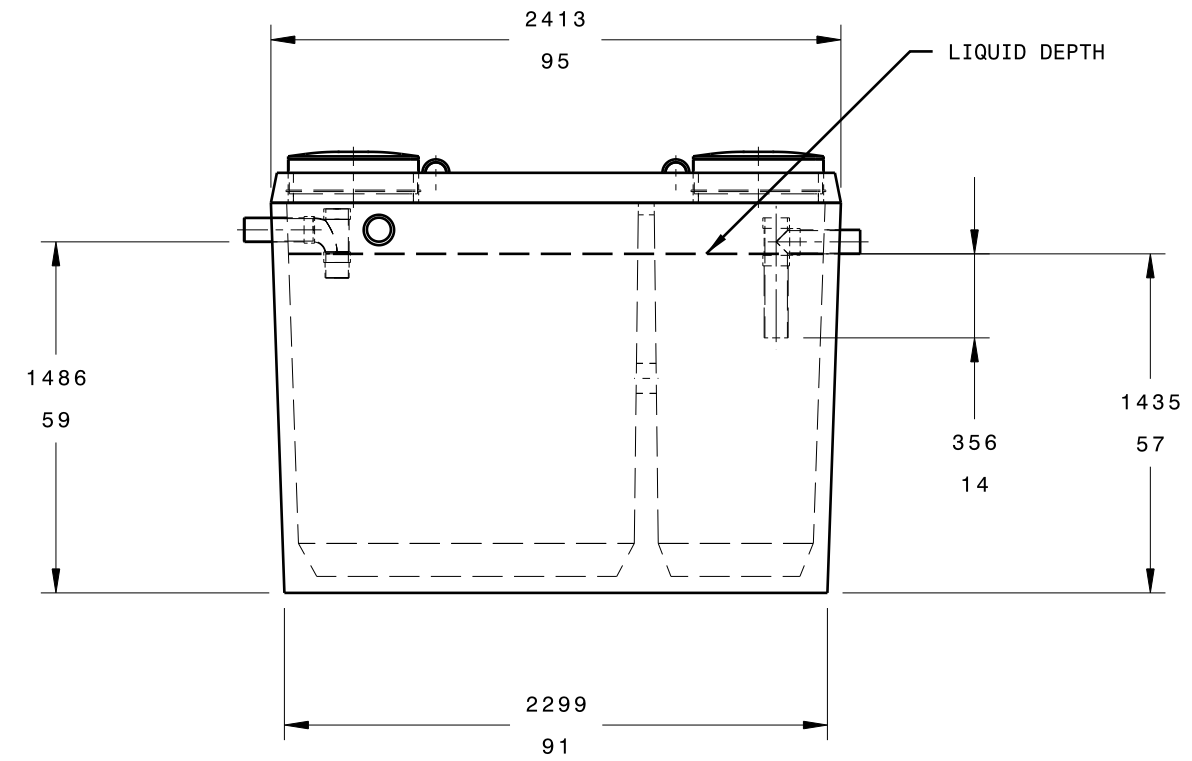

Front view

LIQUID DEPTH

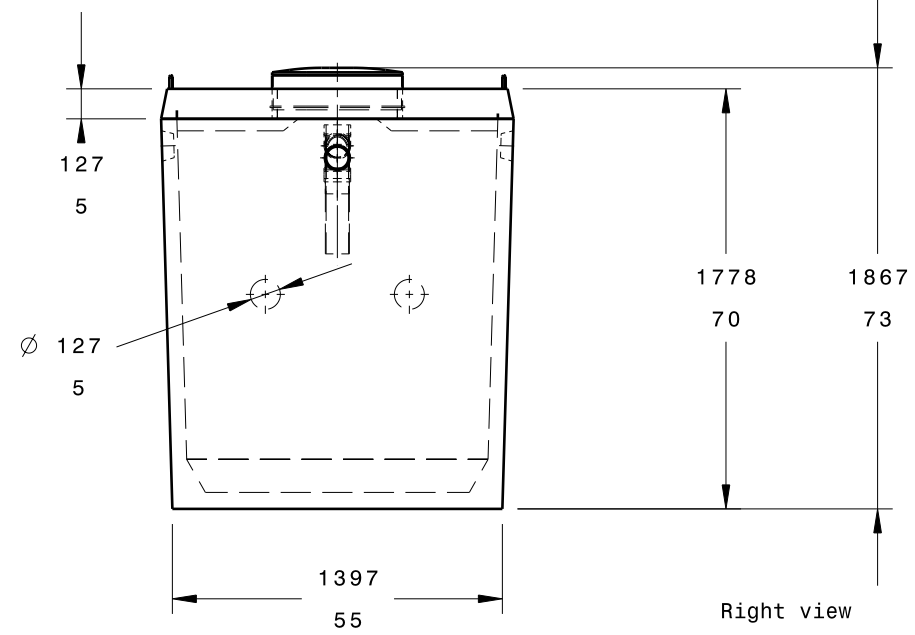

Right view

DESIGNED BY: WJ Reid		REIDS PRECAST CEMENT PRODUCTS LTD R.R. 4 LANGTON, ON NOE 1GO (519) 875-2121	
DATE: 1/10/2007			
CHECKED BY:		3600 LITRE (800 IMP GAL) SEPTIC TANK	
DATE:			
SIZE B		DRAWING NUMBER 3600T	SHEET 1 / 1
SCALE 1:32	WEIGHT (kg)		

This drawing is our property; it can't be reproduced or communicated without our written agreement.

I	—
H	—
G	—
F	—
E	—
D	—
C	—
B	—
A	—