

(2) POLYLOK 508MM (20")  $\varnothing$  RISERS & LIDS  
PART No. 3009, 3009-RC

**NOTE:**  
**MATERIAL:** CONCRETE 32MPa @ 28 DAYS, NON-SULFATE  
**AIR ENTRAINMENT:** 5-7%  
**REINFORCEMENT:** CAN/CSA-G30.18  
**CONSTRUCTION:** MEETS CSA B66-05  
**TOTAL WEIGHT:** 4900 kg (10,805 LBS)  
**TOTAL VOLUME:** 4500 L  
**MONOLITHIC CAST CHAMBER DIVIDER**  
**INLET/OUTLET:** CAST-IN 102mm (4")  $\varnothing$  GASKETED PVC COUPLER  
**BAFFLE:** 102MM (4")  $\varnothing$  PVC  
**JOINT:** N/A  
**ASSEMBLY:** AT FACTORY  
**MAX. BURIAL DEPTH:** 1.2M (47.25")  
**ALL DIMENSIONS IN MM**  
**INCHES**

SPECIFICATION PLATE  
LOCATION

Top view

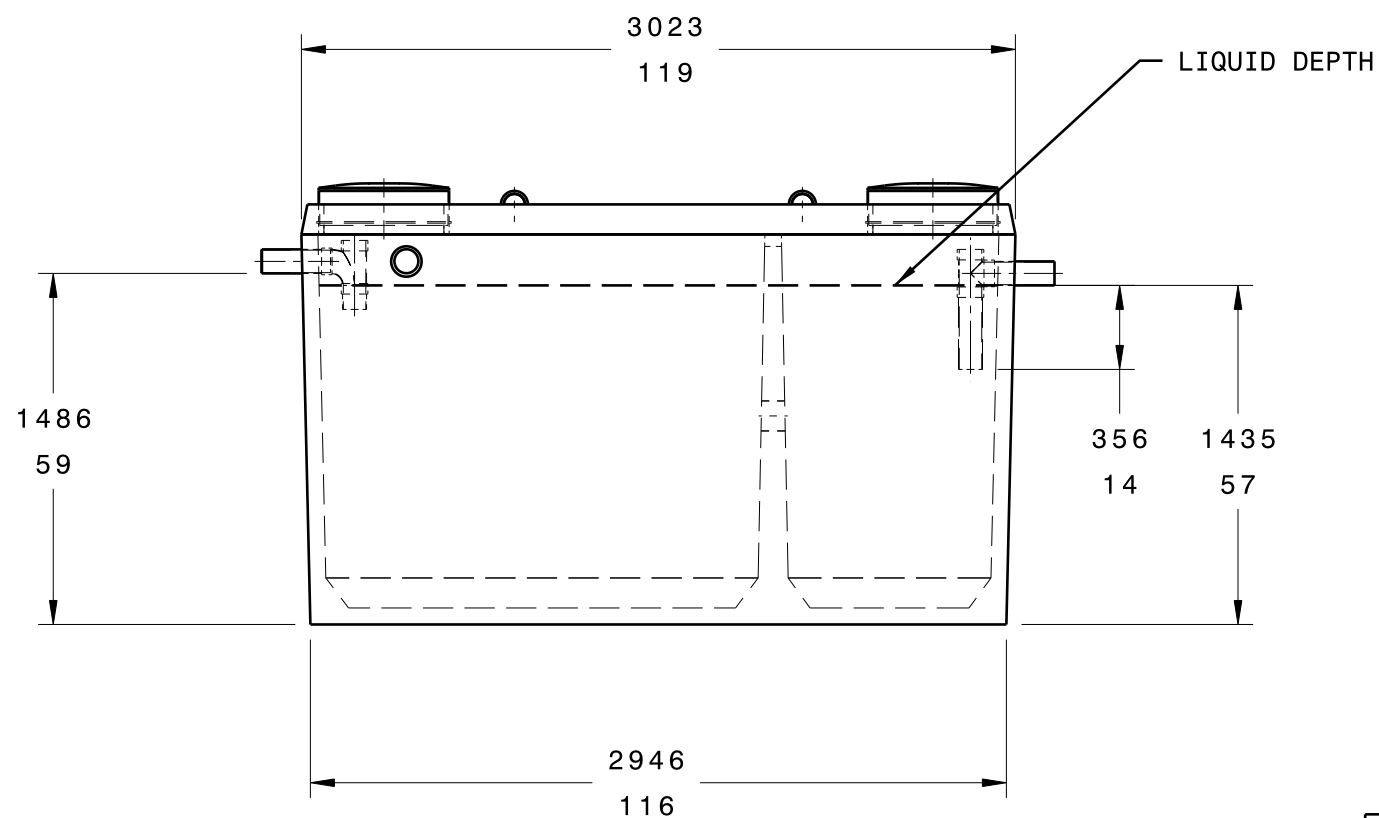

LIQUID DEPTH

Front view

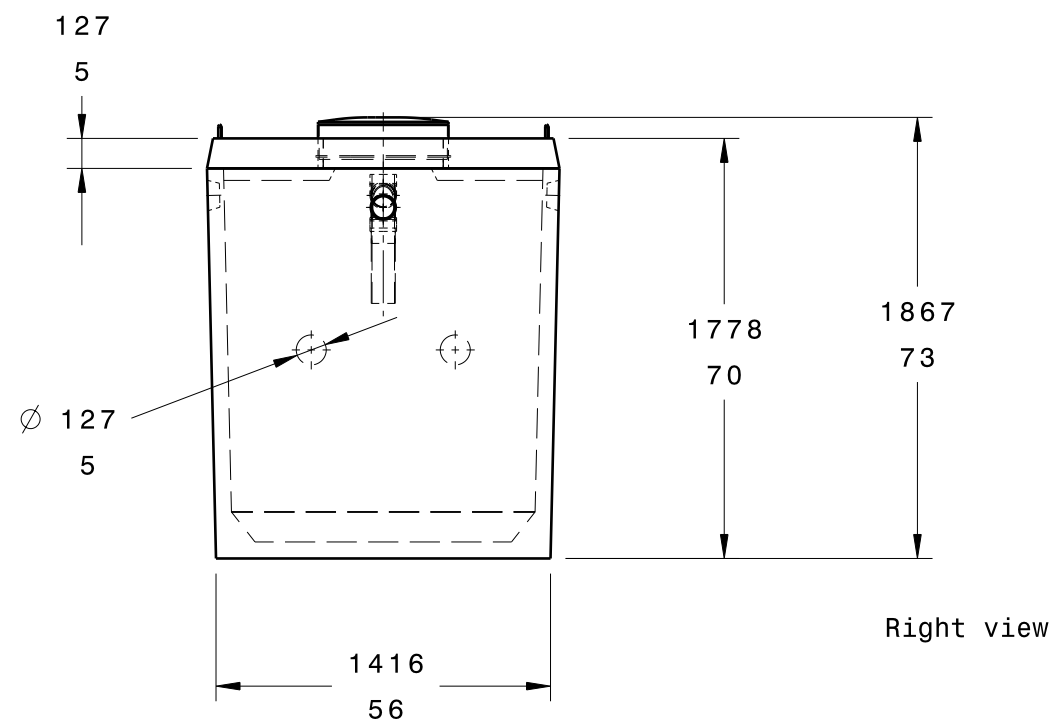

Right view

DESIGNED BY: WJ Reid		<b>REIDS PRECAST CEMENT PRODUCTS LTD</b> R.R. 4 LANGTON, ON NOE 1GO (519) 875-2121		I	-
DATE: 3/29/2005				H	-
CHECKED BY:		<b>4500 LITRE (1000 IMP GAL) SEPTIC TANK</b>		G	-
DATE:				F	-
SIZE <b>B</b>		DRAWING NUMBER <b>4500T</b>		E	-
SCALE <b>1:32</b>	WEIGHT (kg)			C	-
		SHEET <b>1/1</b>		B	-
				A	-

This drawing is our property; it can't be reproduced or communicated without our written agreement.